







BED TYPE		
	AREA	QTY
 DOUBLE OCCUPANCY (2)	770	5
 SINGLE OCCUPANCY (1)	112	1
 TRIPLE OCCUPANCY (3)	241	1
TOTAL:	1,123	7
GROSS:	4,241	

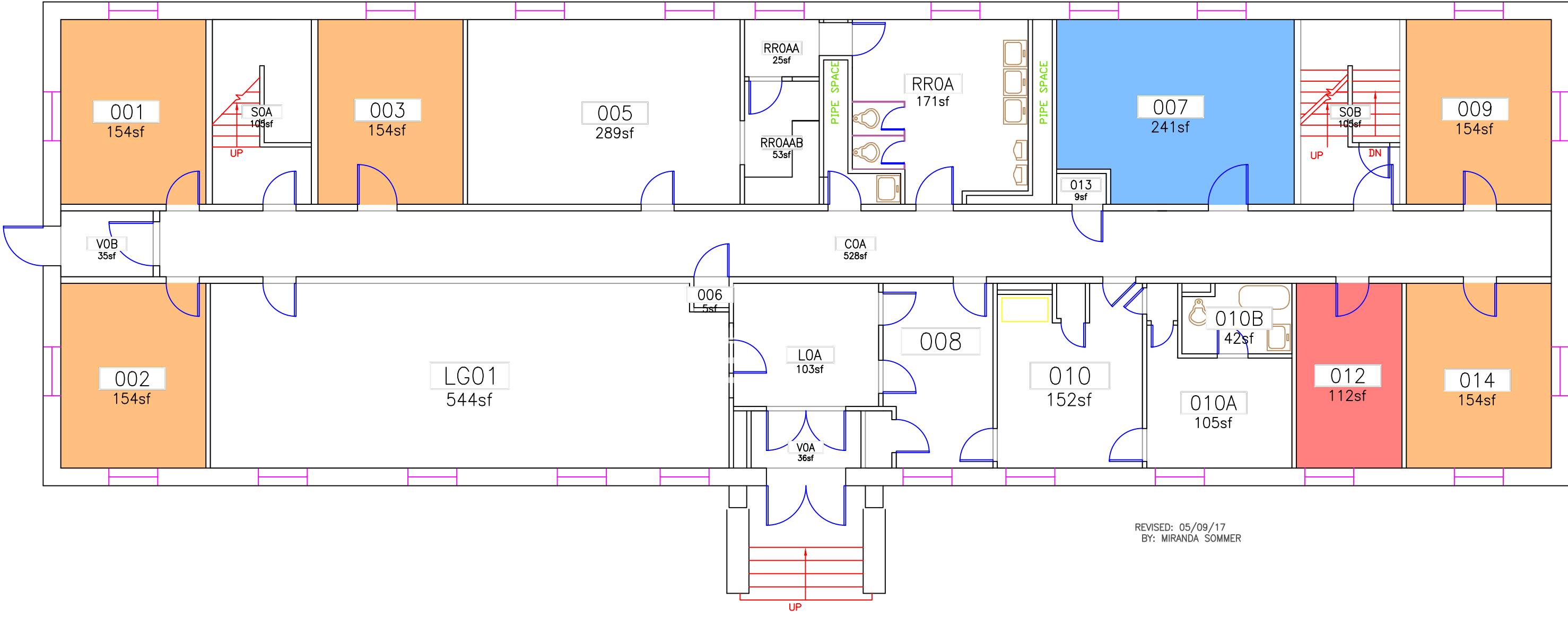

REVISED: 05/09/17
 BY: MIRANDA SOMMER

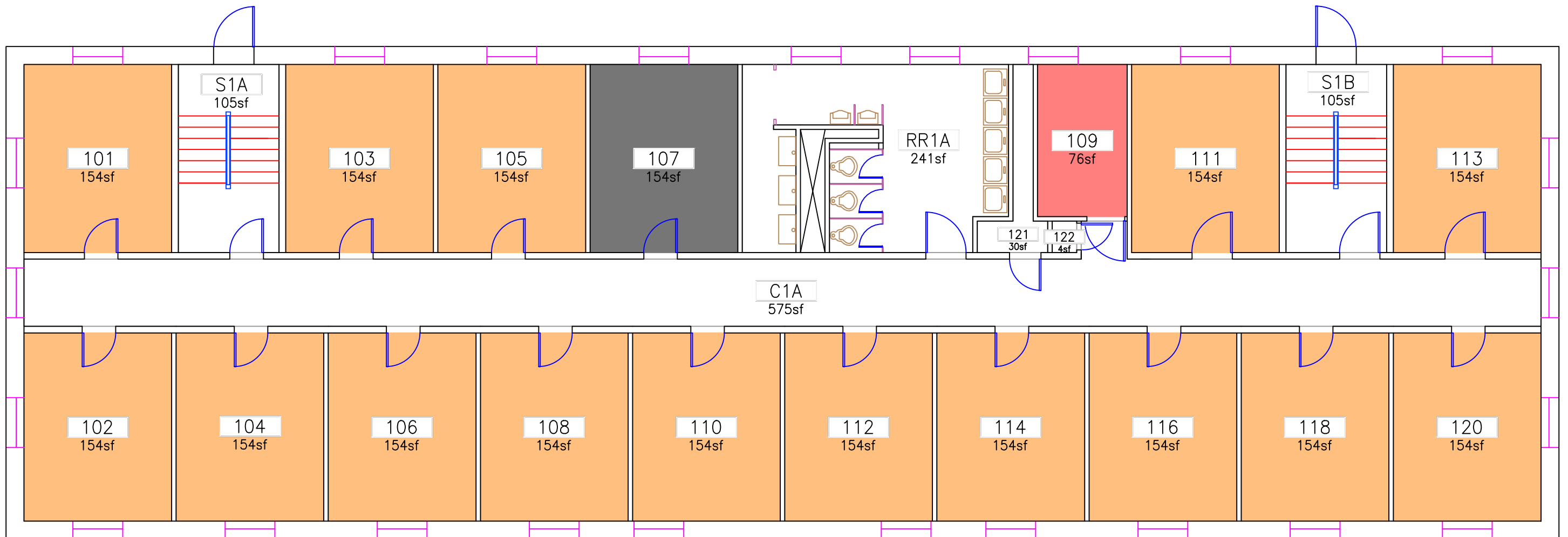

0177 UConn Grange Hall - G

BED TYPE			
		AREA	QTY
	DOUBLE OCCUPANCY (2)	2,310	15
	RESIDENT ASSISTANT	154	1
	SINGLE OCCUPANCY (1)	76	1
TOTAL:		2,540	17
GROSS:		4,241	



REVISED: 05/09/17
 BY: MIRANDA SOMMER

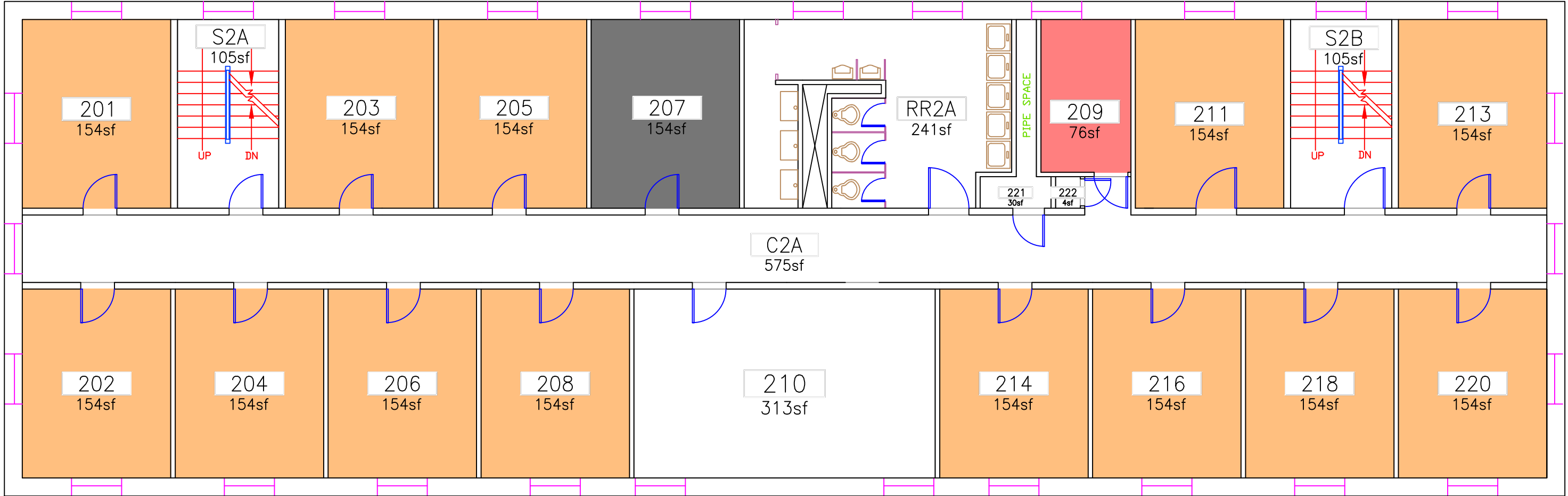

0177 UConn Grange Hall - 01

BED TYPE		
	AREA	QTY
 DOUBLE OCCUPANCY (2)	2,002	13
 RESIDENT ASSISTANT	154	1
 SINGLE OCCUPANCY (1)	76	1
TOTAL:	2,232	15
GROSS:	4,241	



REVISED: 05/09/17
 By: MIRANDA SOMMER

0177 UConn Grange Hall - 02

BED TYPE			
		AREA	QTY
	DOUBLE OCCUPANCY (2)	2,310	15
	RESIDENT ASSISTANT	154	1
	SINGLE OCCUPANCY (1)	76	1
	TOTAL:	2,540	17
	GROSS:	4,241	

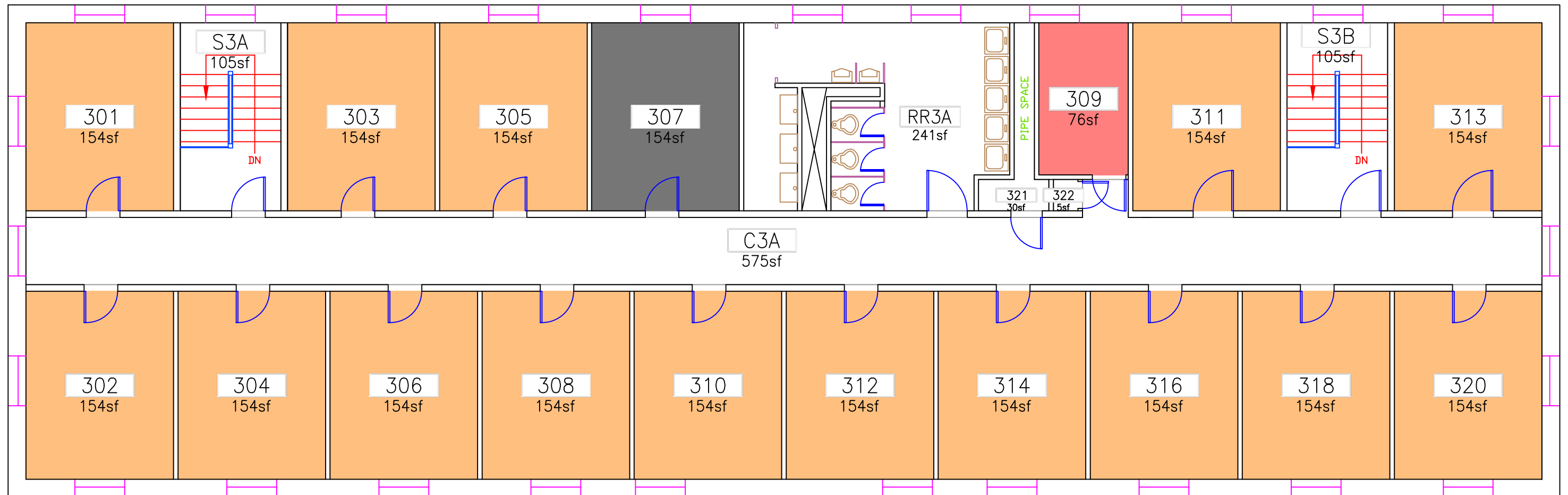

REVISED: 05/09/17
BY: MIRANDA SOMMER

0177 UConn Grange Hall - 03